

Style 50 swivel joints(Long radius)
Non-pressure seal and integral straight pipes

Short radius swivel joints
and integral straight pipes

Long radius swivel joints
and integral straight pipes

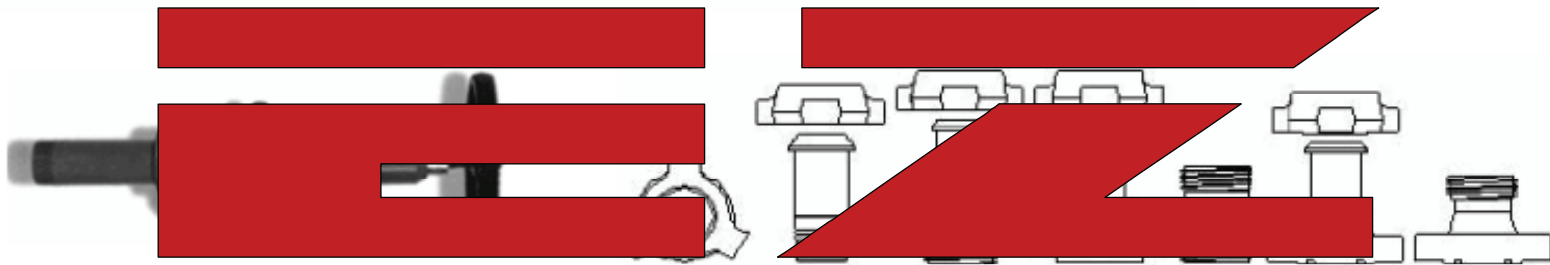

FLOW

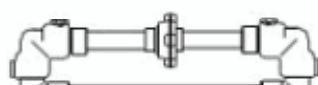
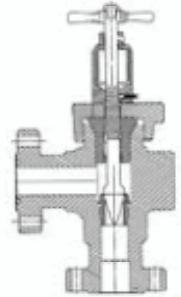
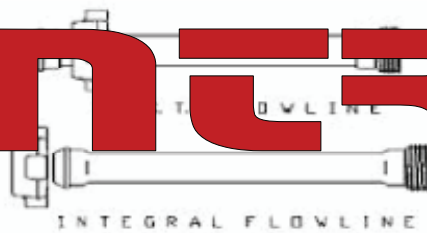
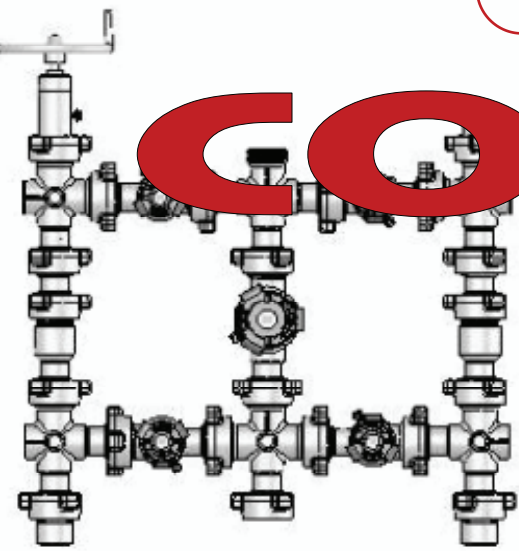

CONTROL



CONTROL

EZ FLOW CONTROL INC.'s Adjustable Choke assemblies and Long Nose Heater Choke assemblies are furnished with Alloy and or Harden Steel Stems and Seats as Standard Trim for Regular or Standard Service. Stainless Steel or Stainless Steel with Tungsten Carbide Trim Sets for Abrasive and or Sour Gas Service are available on request. **Positive Choke** assemblies are furnished *less flow bean*. **Positive choke** assemblies may be converted to **Adjustable Choke** assemblies by replacing the blanking cap assembly and flow bean with the appropriate adjustable bonnet assembly and seat.

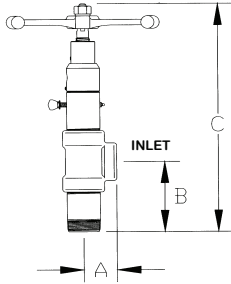

EZ 29

EZ FLOW Model	Inlet	Outlet	Working Pressure	Orifice Size	Dimensions		
					A	B	C
EZ 29	2" FLP	2" MLP	2,000	3/4" & 1"	2.38"	5.31"	16.31"
EZ O60	2" FLP	2" MLP	3,000	3/4" & 1"	2.50	7.44"	22.50"
EZ O63	3" FLP	3" MLP	3,000	2"	4.25	7.50	25.00"

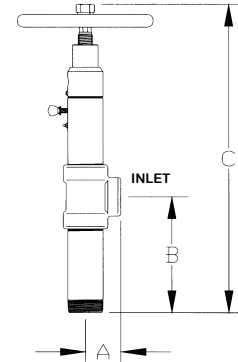

EZ O60

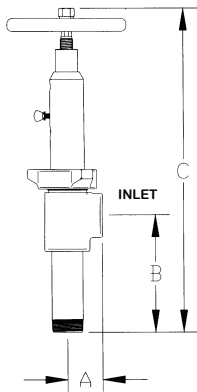

EZ N60

EZ FLOW Model	Inlet	Outlet	Working Pressure	Orifice Size	Dimensions		
					A	B	C
EZ N60	2" FLP	2" MLP	5,000	3/4" & 1"	2.75"	9.00	23.50"
EZ FT108	2" FLP	2" MLP	5,000	1" Max	2.75"	9.00	13.00"

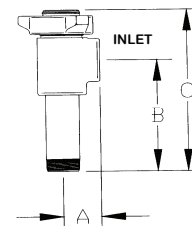

EZ FT108

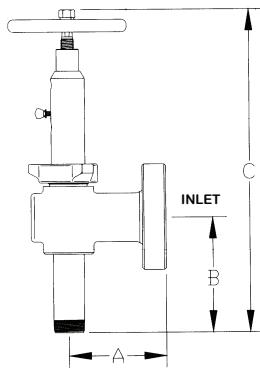

EZ FT116A

EZ FLOW Model	Inlet	Outlet	Working Pressure	Orifice Size	Dimensions		
					A	B	C
EZ FT116A	2-1/16 5m	2" MLP	5,000	3/4" & 1"	6.63"	9.00"	23.50"
EZ FT116P	2-1/16 5m	2" MLP	5,000	1" Max	6.63"	9.00"	13.50"

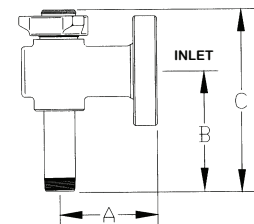

EZ FT116P



The following **Flange Chokes** are manufactured in **Alloy** or **Stainless Steel** bodies. **Standard** or **Stainless –Steel Tungsten– Carbide trim** offered. **Standard** and **H2S** configurations available.

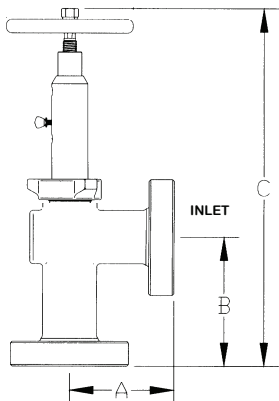

EZ N62

EZ FLOW Model	Flange Size Inlet & Outlet	Working Pressure	Orifice Size	Dimensions		
				A	B	C
EZ N62 EZ T1	2-1/16" 2m 2-1/16" 2m	2,000 2,000	3/4" & 1" 1" Max	7.50" 7.50"	9.38" 9.38"	24.38" 14.50"
EZ N62 EZ T1	2-1/16" 5m 2-1/16" 5m	5,000 5,000	3/4" & 1" 1" Max	7.50" 7.50"	9.38" 9.38"	24.38" 13.88"
EZ N62 EZ T1	150 ANSI RF 150 ANSI RF	275 275	3/4" & 1" 1" Max	7.50" 7.50"	9.38" 9.38"	24.38" 14.13"
EZ N62 EZ T1	300 ANSI RF 300 ANSI RF	720 720	3/4" & 1" 1" Max	7.50" 7.50"	9.38" 9.38"	24.38" 14.13"
EZ N62 EZ T1	600 ANSI RF 600 ANSI RF	1,440 1,440	3/4" & 1" 1" Max	7.50" 7.50"	9.38" 9.38"	24.38" 14.13"

ANSI R.T.J. available on request

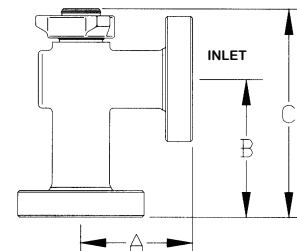

EZ T1

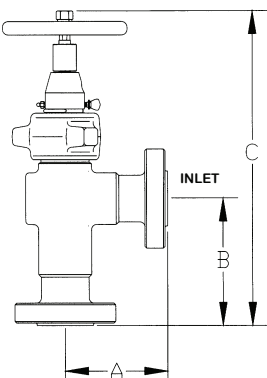

EZ JWA

EZ FLOW Model	Flange Size Inlet & Outlet	Working Pressure	Orifice Size	Dimensions		
				A	B	C
EZ JWA EZ PC	2-1/16" 5m 2-1/16" 5m	5,000 5,000	3/4" & 1" 1" Max	7.50" 7.50"	9.38" 9.38"	20.81" 14.13"
EZ JWA EZ PC	1-13/16" 10m 1-13/16" 10m	10,000 10,000	3/4" & 1" 1" Max	7.50" 7.50"	9.19" 9.19"	21.06" 14.13"
EZ JWA EZ PC	2-1/16" 10m 2-1/16" 10m	10,000 10,000	3/4" & 1" 1" Max	7.50" 7.50"	9.38" 9.38"	21.38" 16.31"
EZ JWA EZ PC	1-13/16" 15m 1-13/16" 15m	15,000 15,000	3/4" & 1" 1" Max	7.38" 7.38"	10.13" 10.13"	26.06" 18.88"
EZ JWA EZ PC	2-1/16" 15m 2-1/16" 15m	15,000 15,000	3/4" & 1" 1" Max	7.38" 7.38"	10.13" 10.13"	26.06" 18.88"

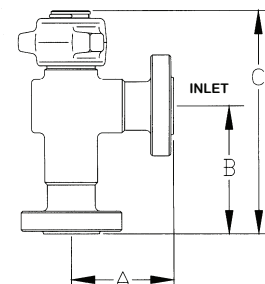

EZ PC

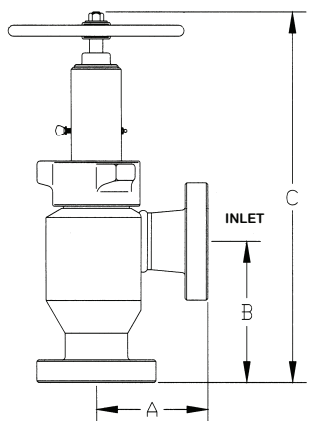

EZ H2A

EZ FLOW Model	Flange Size Inlet & Outlet	Working Pressure	Orifice Size	Dimensions		
				A	B	C
EZ H2A EZ H2P	3-1/8" 3m 3-1/8" 3m	3,000 3,000	1", 1-3/4" & 2" 2" Max	8.88" 8.88"	11.38" 11.38"	30.00" 18.50"
EZ H2A EZ H2P	2-1/16" 5m 2-1/16" 5m	5,000 5,000	1", 1-3/4" & 2" 2" Max	7.50" 7.50"	9.38" 9.38"	30.00" 18.50"
EZ H2A EZ H2P	2-9/16" 5m 2-9/16" 5m	5,000 5,000	1", 1-3/4" & 2" 2" Max	8.88" 8.88"	11.38" 11.38"	30.00" 18.50"
EZ H2A EZ H2P	3-1/8" 5m 3-1/8" 5m	5,000 5,000	1", 1-3/4" & 2" 2" Max	8.88" 8.88"	11.38" 11.38"	30.00" 18.50"
EZ H2A EZ H2P	2-9/16" 10m 2-9/16" 10m	10,000 10,000	1", 1-3/4" & 2" 2" Max	10.38" 10.38"	11.75" 11.75"	30.25" 18.75"
EZ H2A EZ H2P	3-1/16" 10m 3-1/16" 10m	10,000 10,000	1", 1-3/4" & 2" 2" Max	10.38" 10.38"	11.75" 11.75"	30.25" 18.25"

2" Max orifice chokes are also available with 3" ANSI 150 - ANSI 1500 R.F. or R.T.J.

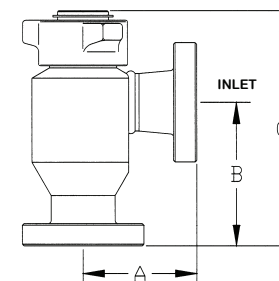

EZ H2P

TYPICAL PARTS ORDERING INFORMATION

ADJUSTABLE CHOKES

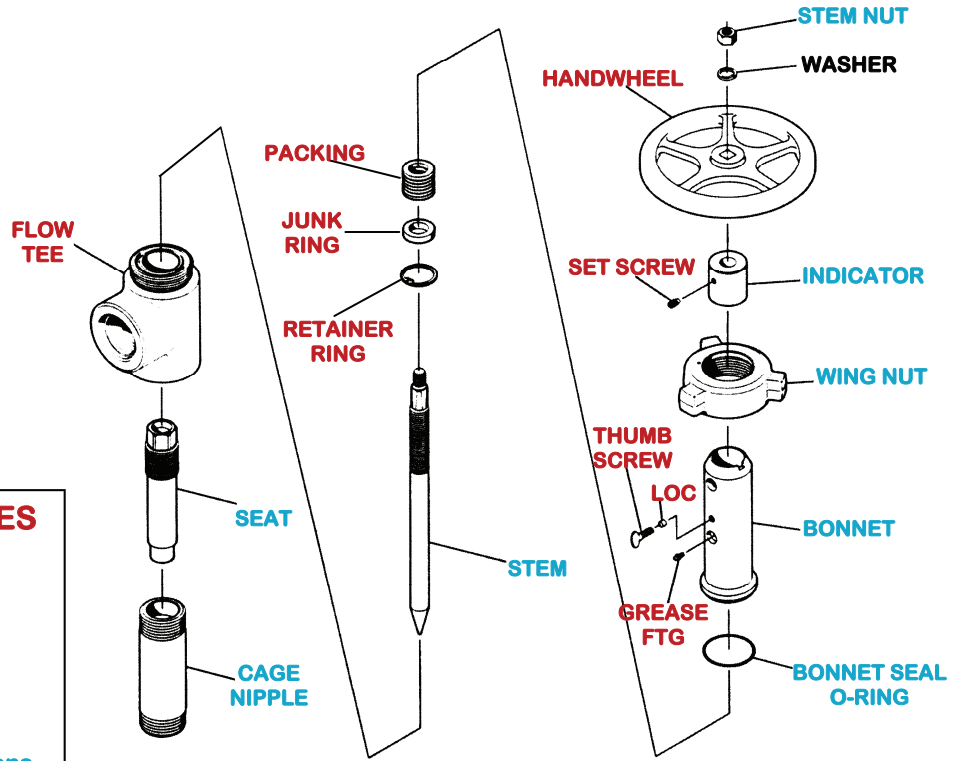

Typical Threaded Adjustable Choke

TIPS TO ORDER CHOKES

1. Type of Choke - "Positive or Adjustable"
2. Specify Working Pressure.
3. Type of Inlet & Outlet Connections, Size and Pressure Rating.
4. Specify Trim Size (Orifice Required)
5. Trim Material - "Alloy Steel, Stainless Steel, Stainless Steel / Tungsten Carbide"
6. Specify Heater Choke if applicable.

Positive Choke assemblies are furnished *less* Flow Bean.

POSITIVE CHOKES

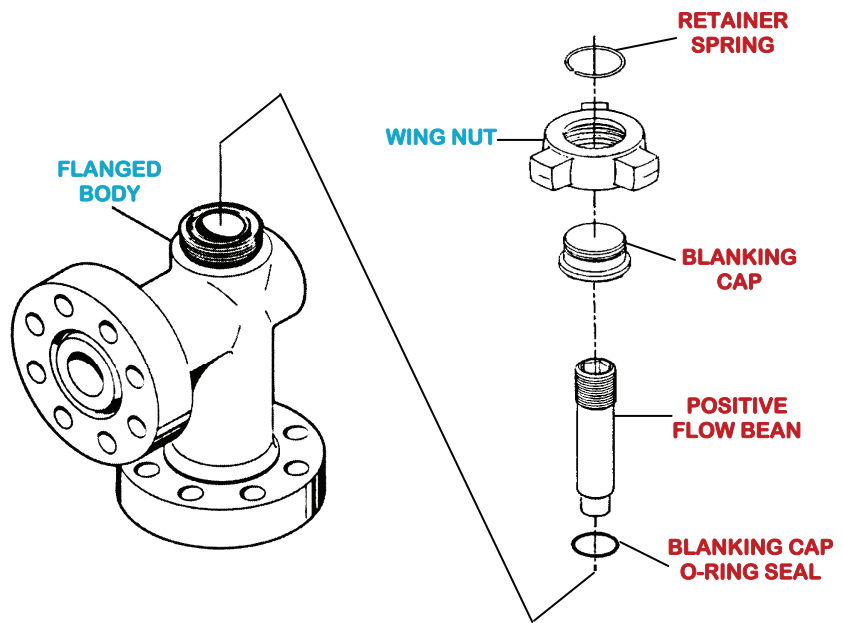

Typical Flanged End Positive Choke



TRIM: HARDENED STEEL, STAINLESS-STEEL,

CONTROL

STAINLESS STEEL TUNGSTEN-CARBIDE

OIL CENTER TOOL

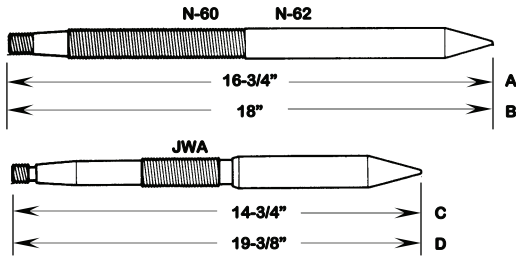

A— 16-3/4"	0-60 / N-60 / FT-116A	426161 SS/TC
B— 18"	N-62	426162 SS/TC
C— 14-3/4"	JWA 5m / 10m	426555 SS/TC
D— 19-3/8"	JWA 15m	426556 SS/TC

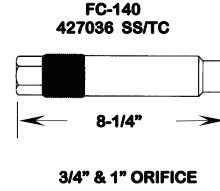

THORNHILL-CRAVER

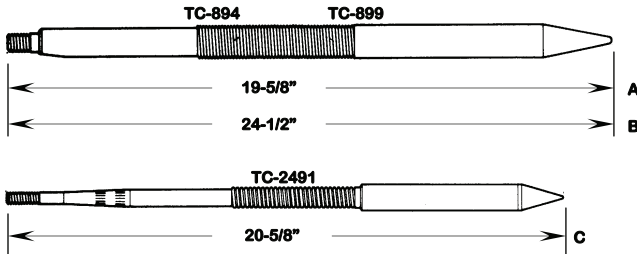

A— 19-5/8"	TC-894 3m / 5m / 10m	526012 SS/TC
B— 24-1/2"	TC-899 3m / 5m / 10m HEATER	526032 SS/TC
C— 20-5/8"	TC-2491 15m HEATER	526042 SS/TC

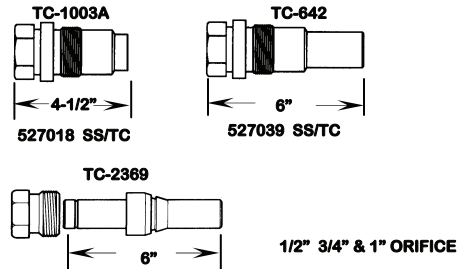

CAMERON IRON WORKS

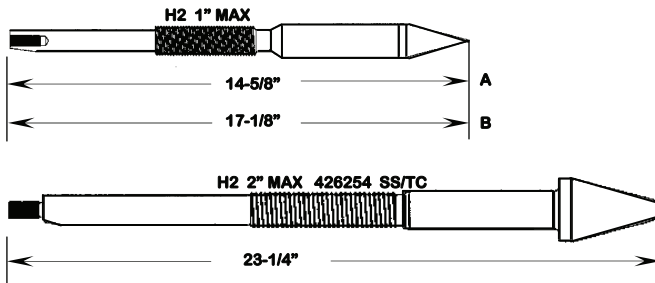

A— 14-5/8"	H2 1" MAX 3m / 5m / 10m	626144 SS/TC
B— 17-1/8"	H2 1" MAX 15m	626244 SS/TC

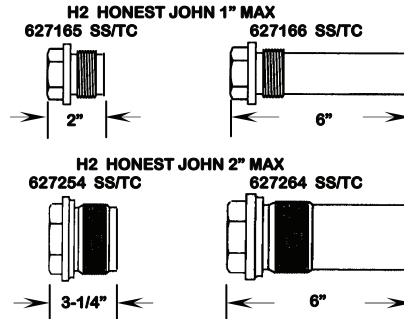

GRAY TOOL COMPANY

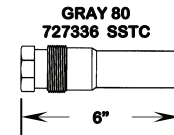
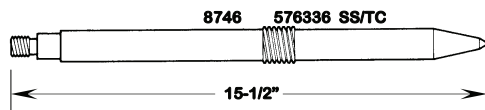

GULFCO

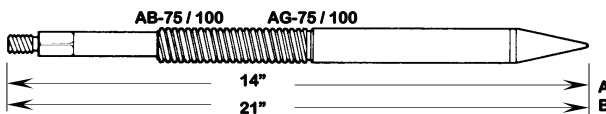

A— 14"	AB-75 & AB-100	826336 SS/TC
B— 21"	AG-75 & AG-100 HEATER	826346 SS/TC

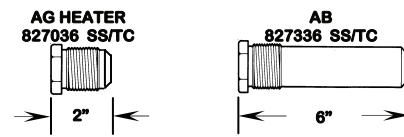

STEMS, SEATS & OTHER TRIM SETS FOR O.E.M.'s ARE AVAILABLE ON REQUEST

ALL DIMENSIONS ARE APPROXIMATE

EZFC's PART # ARE FOR 3/4" SS/TC TRIM UNLESS NOTED



TRIM MATERIAL OFFERED:

CERAMIC
TUNGSTEN CARBIDE
TUNGSTEN CARBIDE

6" insert
1" insert
6" insert

Orifice sizes 4/64" — 48/64"
Orifice sizes 4/64" — 128/64"
Orifice sizes 4/64" — 128/64"

CHOKEFLOW BEANS available in ALLOY STEEL or STAINLESS STEEL jackets

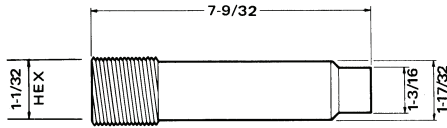

OIL CENTER TOOL

"FC-140"

EZ # 4530xx AS/CER

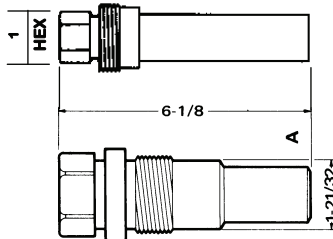

THORNHILL-CRAVER

"TC-1017"

EZ # 5539xx AS/CER

"TC-1003 P"

EZ #5530xx AS/CER

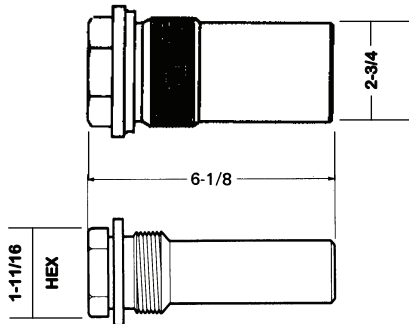

CAMERON IRON WORKS

"BIG JOHN 2" MAX"

EZ #653xxx AS/CER

"BIG JOHN 1" MAX"

EZ #6531xx AS/CER

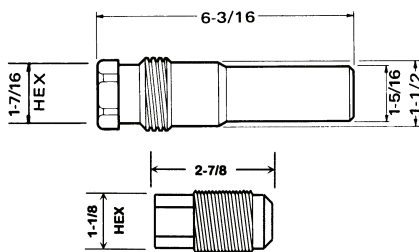

GRAY TOOL COMPANY

"GRAY 80"

EZ #7530xx AS/CER

"GRAY 40"

EZ #7534xx AS/CER

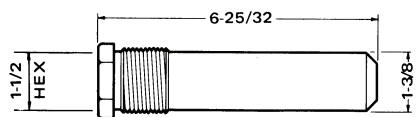

GULFCO

"RB"

EZ #7630xx AS/CER

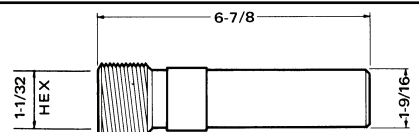

NATIONAL SUPPLY

EZ #7730xx AS/CER

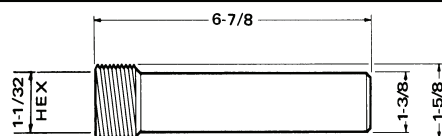

Mc EVOY & HUGH ATLAS

"R"

EZ #5630xx AS/CER

ALL DIMENSIONS ARE APPROXIMATE

FLOW BEANS

ALLOY STEEL

OIL CENTER TOOL
FC-142 P
EZ # 4505xx
20/64" MAX



THORNHILL-CRAVER
TC-575 "X"
EZ # 5505xx
14/64" MAX

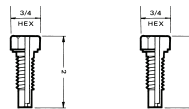

CAMERON IRON WORKS
HONEST JOHN
EZ # 6505xx
40/64" MAX



MASTER BEANS

ALLOY STEEL

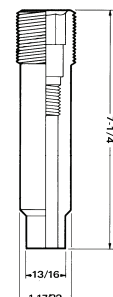

FC-141
EZ # 450141

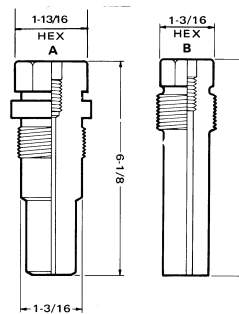

TC-574 **TC-573**
EZ # 550574 EZ # 750573

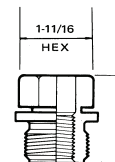

BIG JOHN 1" MAX
EZ # 650101

FLOW BEAN ADAPTERS

ALLOY STEEL
STAINLESS STEEL

BJ 2" MAX x BJ 1" MAX
EZ # 650102

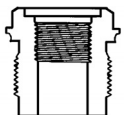

BJ 2" MAX x OCT FC-140
EZ # 650140

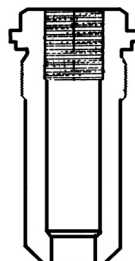

FLOW BEAN WRENCHES

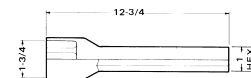

OCT FC-140
EZ #439012

OCT FC-143
EZ #439015

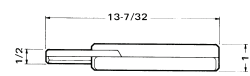

OTHER WRENCHES ALSO AVAILABLE

CAGE NIPPLES

CHOKE NIPPLES

ALLOY STEEL

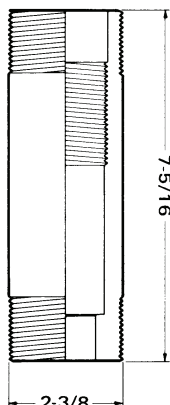

OCT
"FC140"
EZ # 429011

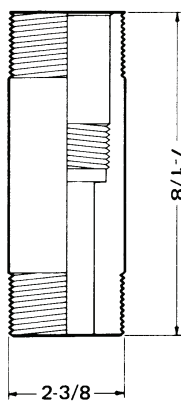

THORNHILL
CRAVER
"TC-1018"
EZ # 529018

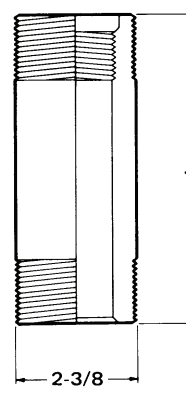

Mc EVOY
"R"
EZ # 759017

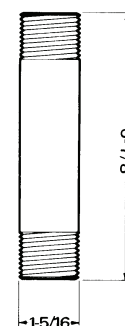

CHOKE NIPPLES
1" x 4" 1" x 6"
2" x 6"

ALL DIMENSIONS ARE APPROXIMATE

LONG NOSE HEATER CHOKES

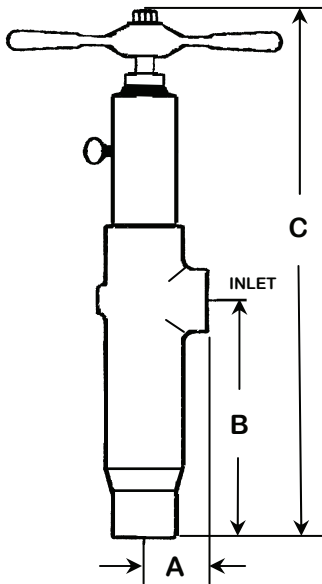

EZ FLOW Model	Inlet	Outlet	Working Pressure	Orifice Size	A	Dimensions B C	
EZ 65LHC EZ 65SHC	2" FLP 2" SW	2" FLP 2" SW	6,500 6,500	1/2", 3/4" & 1" 1/2", 3/4" & 1"	3.25"	12.25"	28.50"
EZ 78LHC EZ 78SHC	2" FLP 2" SW	2" FLP 2" SW	7,800 7,800	1/2", 3/4" & 1" 1/2", 3/4" & 1"	3.25"	12.25"	28.50"
EZ 94BHC	2"XX BW	2"XX BW	9,400	1/2", 3/4" & 1"	5.38"	12.50"	30.00"

EZ FLOW CONTROL'S Long Nose Heater Chokes
Are available for **Sour Service**

TYPICAL PARTS ORDERING INFORMATION

LONG NOSE HEATER CHOKE

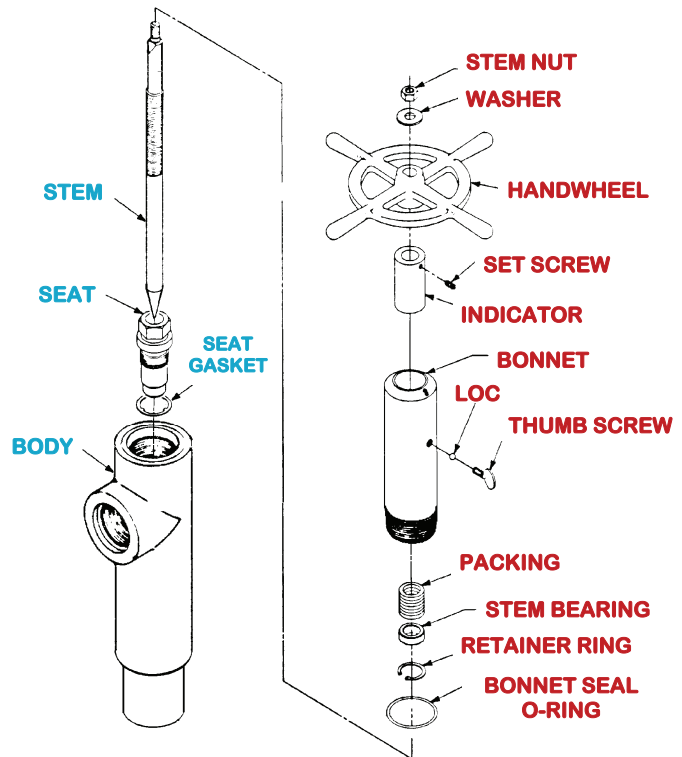

Typical Threaded Long Nose Heater Choke



CONTROL

EZ FLOW CONTROL INC. offers our

"EZ-TXS" Adjustable Choke with the following:

**EZ-TXS
ADJUSTABLE
CHOKE
w/ 2" 1502
HAMMER UNION
CONNECTIONS**

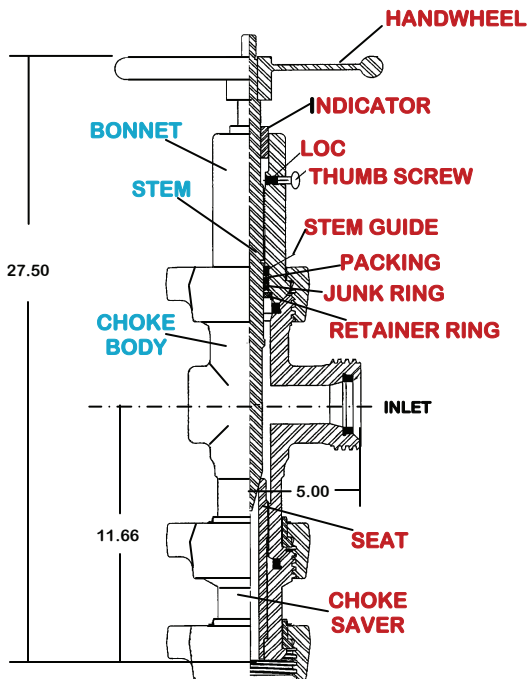

WORKING PRESSURE

10,000 & 15,000 NSCP

END CONNECTIONS

2" Fig 1502 HAMMER UNION

ORIFICE SIZE

3/4" STD - 1" MAX

TRIM MATERIAL

STAINLESS STEEL w/
TUNGSTEN CARBIDE
(SEAT IS FULL LINED)

EZ-TXS Adjustable Choke assembly may be converted to a EZ-TXS Positive Choke assembly by replacing the bonnet assembly and seat with the appropriate blanking cap assembly and flow bean.

**HAMMER UNION
FITTINGS & ADAPTERS**

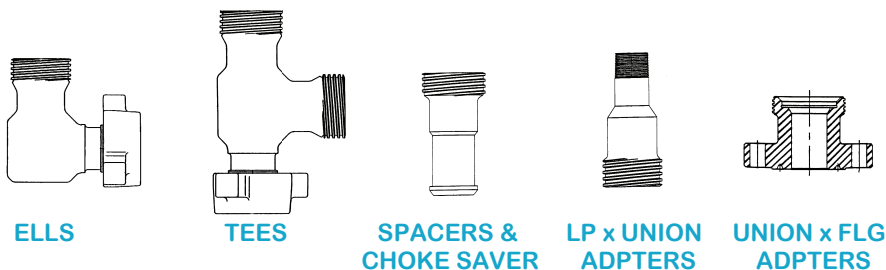

**THREADED
FITTINGS & ADAPTERS**

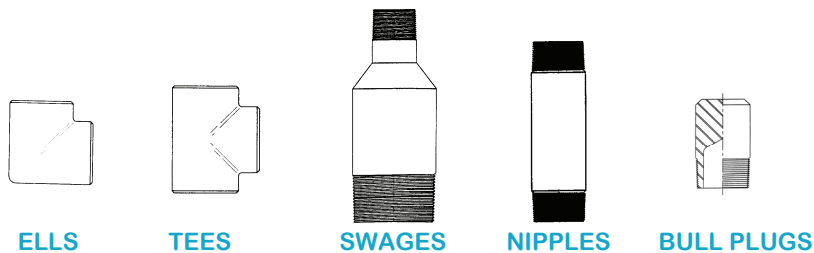

EZ FLOW CONTROL INC. Offers Mud Nipples & Nozzles with the following 1" liners:
CERAMIC & TUNGSTEN CARBIDE
Stock 1/4", 3/8", 1/2", 5/8", & 3/4"

**MUD GUN
NOZZLES**

ALLOY
STAINLESS STEEL

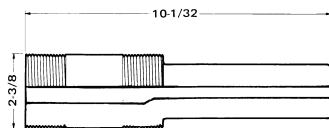

MUD MIXING NIPPLE

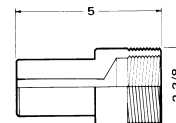

MUD GUN NOZZLE

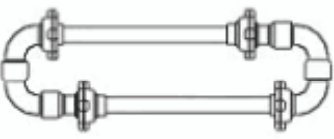
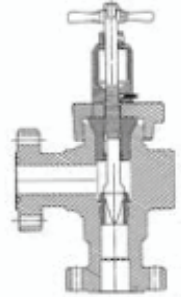
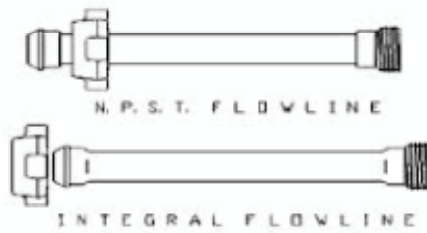
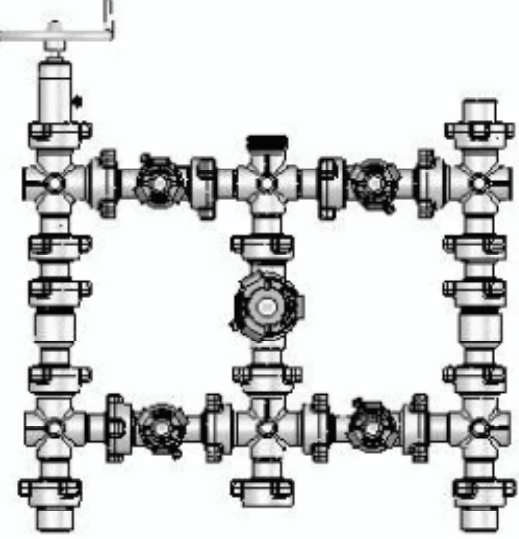

Style 50 swivel joints(Long radius)
Non-pressure seal and integral straight pipes

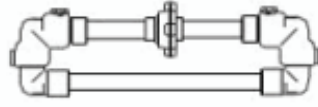

Short radius swivel joints
and integral straight pipes

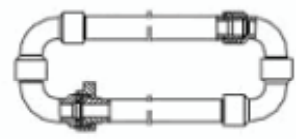

Long radius swivel joints
and integral straight pipes

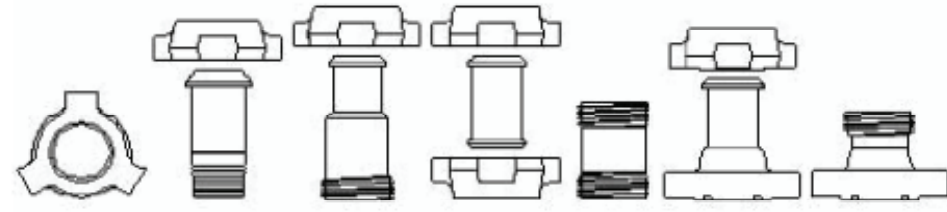

EZ FLOW CONTROL INC.

