



EZ FLOW

CONTROL

PRODUCT CATALOG

A Division of BelGAS CP

EZ Flow History

Bringing more than 50 years experience of quality chokes, flow beans, manifolds, Talco red iron and trim sets to the BelGAS group of Companies, EZ-Flow Control stands ready to provide an even more extended line of parts for another 50 years under the BelGASCP division. From retro fitting older parts to completely new builds, EZ Flow has what you need to keep the flow moving and regulated.

Whether just a small order to get by or a major overhaul, the quality products that we have provided for now our 2nd generation, will never waiver from the superior quality you have come to expect.

Visit our website at www.ezflowcontrol.com. To learn more about the entire family of BelGAS products, visit our parent company's website www.belgascp.com

ADJUSTABLE CHOKES

POSITIVE CHOKES

ORDERING INFORMATION

ADJUSTABLE CHOKES

EZ TIPS TO ORDER CHOKES

1. Type of Choke "Positive or Adjustable"
2. Specify Working Pressure.
3. Type of Inlet & Outlet Connections, Size and Pressure Rating.
4. Specify Trim/
Orifice Size Required
5. Trim Material
"Alloy Steel, Stainless Steel,
Stainless Steel-Tungsten Carbide"
6. Specify Heater Choke if applicable.

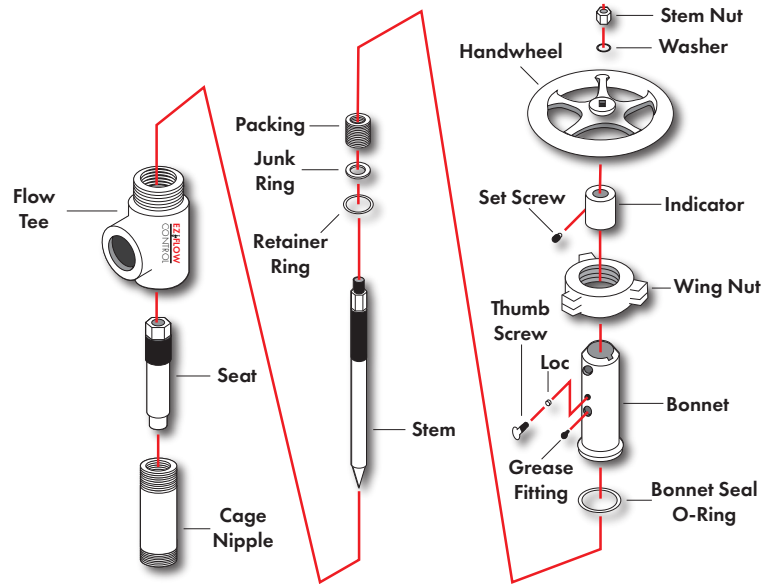

TYPICAL THREADED ADJUSTABLE E-N60 CHOKE

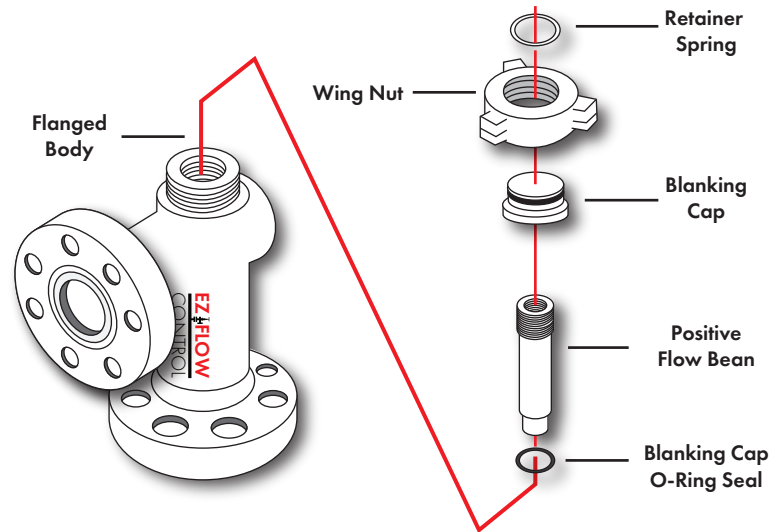

TYPICAL FLANGED END POSITIVE E-T1 CHOKE

All Positive Choke assemblies are furnished without Flow Bean.

POSITIVE CHOKES

THREADED CHOKES

EZ FLOW CONTROL'S Threaded adjustable choke assemblies can be furnished with either hardened steel or stainless tungsten carbide trim. EZ Flow offers threaded chokes for 2" and 3" line pipe connections with pressure ranges from 2M-5M with ¾", 1", and 2" trim options.

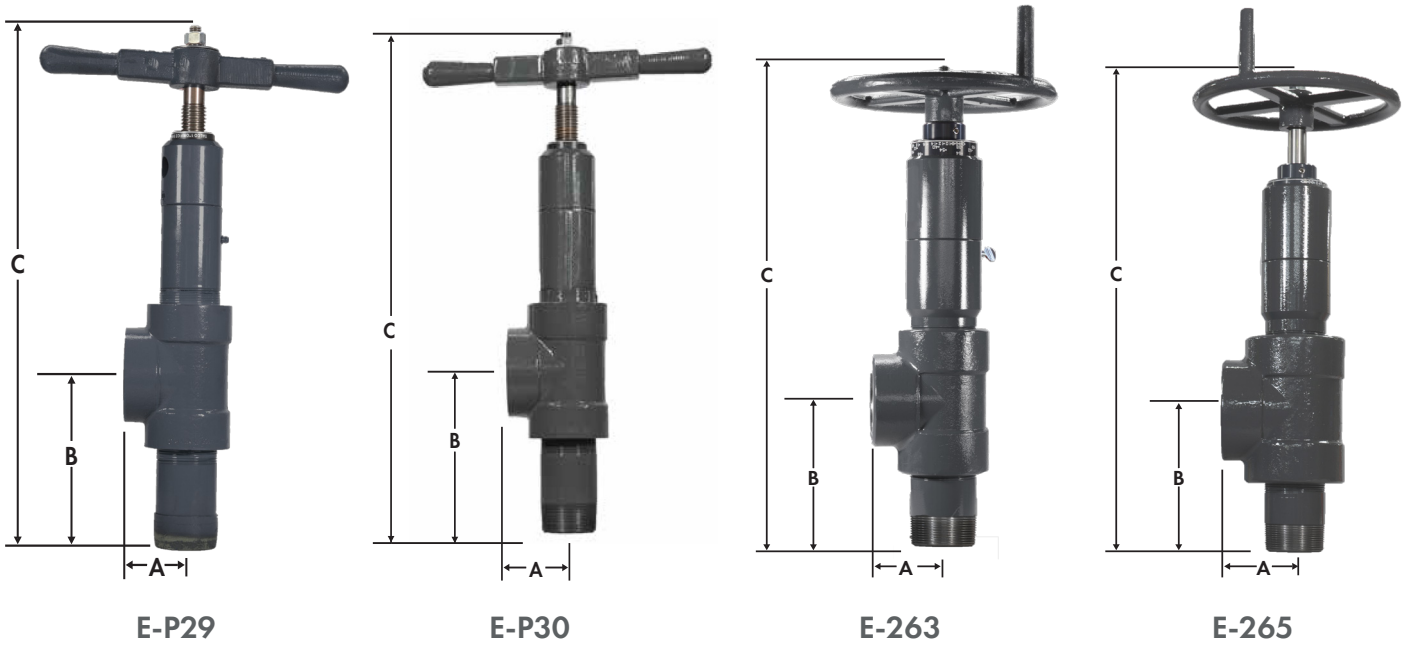

EZ FLOW MODEL	Inlet/Outlet	Working Pressure	Orifice Size	Dimensions		
				A	B	C
E-P29	2"FLP/2"MLP	2,000	¾" & 1"	2.38"	5.31"	16.31"
E-P30	2"FLP/2"MLP	3,000	¾" & 1"	2.50"	7.44"	22.50"
E-263	3"FLP/3"MLP	3,000	2"	3.75"	7.75"	25.00"
E-265	3"FLP/3"MLP	5,000	2"	4.25"	8.00"	25.00"

EZ FLOW FEATURES:

- Wide range of applications
- Trim available with alloy steel, stainless steel, and stainless steel-tungsten carbide
- Positive Chokes are available on request
- Indicator in 64ths, Stem Loc, Stem lubrication fitting
- NACE/H2S service configurations are available upon request.

THREADED CHOKES

EZ FLOW CONTROL'S positive threaded choke assemblies can be converted to Adjustable Choke assemblies by replacing the blanking cap assembly and flow bean with the appropriate adjustable bonnet assembly and seat. All positive chokes are furnished without a flow bean.

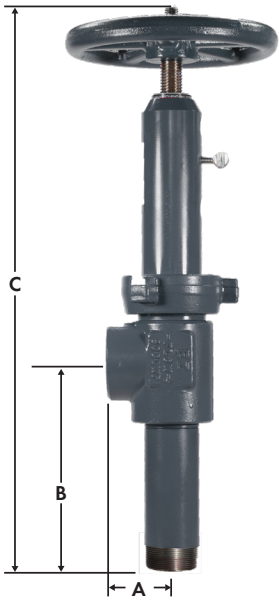

E-N60

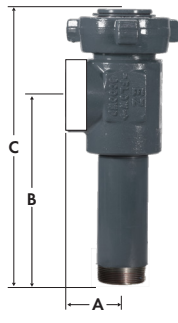

E-FT108

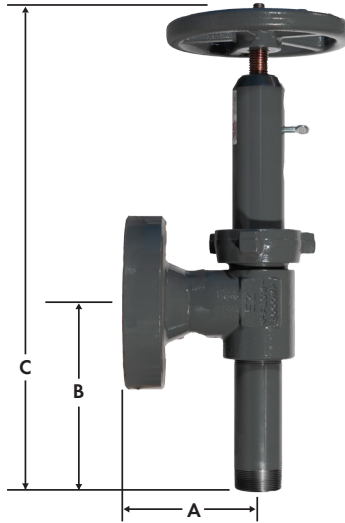

E-FT116A

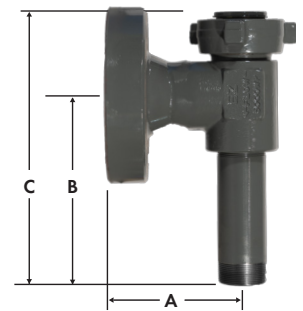

E-FT116P

EZ FLOW MODEL	Inlet/Outlet	Working Pressure	Orifice Size	Dimensions		
				A	B	C
EN60	2"FLP/2"MLP	5,000	3/4" & 1"	2.75"	9.00"	23.50"
EFT108	2"FLP/2"MLP	5,000	1" MAX	2.75"	9.00"	13.00"
FT116-A	2 1/16 5M/2"MLP	5,000	3/4" & 1"	6.63"	9.00"	23.50"
FT116-P	2 1/16 5M/2"MLP	5,000	1" MAX	6.63"	9.00"	13.00"

EZ FLOW FEATURES:

- Bonnet assembly and cap assembly available for easy field repair or conversion
- Variety of trim materials and orifice sizes available for both adjustable and positive chokes
- Replacement seats, stems, choke repair parts, and flowbeans kept in stock
- NACE/H2S configurations available

FLANGED CHOKES

The following flanged chokes are manufactured in alloy or stainless steel bodies. Alloy steel or stainless steel-tungsten carbide available. Standard and H2S configurations available.

EZ FLOW MODEL	Flange Size Inlet/Outlet	Working Pressure	Orifice Size	Dimensions		
				A	B	C
EN62	2 1/16" 2M	2,000	3/4"-1" Max	7.50"	9.38"	24.38"
ET1				7.50"	9.38"	14.50"
EN62	2 1/16" 5M	5,000	3/4"-1" Max	7.50"	9.38"	24.38"
ET1				7.50"	9.38"	13.88"
EN62	150 ANSI RF	275	3/4"-1" Max	7.50"	9.38"	24.38"
ET1				7.50"	9.38"	14.13"
EN62	300 ANSI RF	720	3/4"-1" Max	7.50"	9.38"	24.38"
ET1				7.50"	9.38"	14.13"
EN62	600 ANSI RF	1,440	3/4"-1" Max	7.50"	9.38"	24.38"
ET1				7.50"	9.38"	14.13"

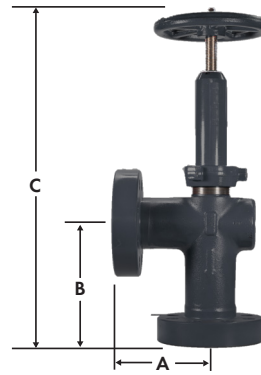

EN62

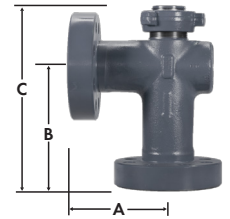

ET1

EZ FLOW MODEL	Flange Size Inlet/Outlet	Working Pressure	Orifice Size	Dimensions		
				A	B	C
EJWA	2 1/16" 5M	5,000	3/4"-1" Max	7.50"	9.38"	20.81"
EPC				7.50"	9.38"	14.13"
EJWA	1 13/16" 10M	10,000	3/4"-1" Max	7.50"	9.38"	20.06"
EPC				7.50"	9.38"	14.13"
EJWA	2 1/16" 10M	10,000	3/4"-1" Max	7.50"	9.38"	21.38"
EPC				7.50"	9.38"	16.31"
EJWA	1 13/16" 15M	15,000	3/4"-1" Max	7.50"	9.38"	26.06"
EPC				7.50"	9.38"	18.88"
EJWA	2 1/16" 15M	15,000	3/4"-1" Max	7.50"	9.38"	26.06"
EPC				7.50"	9.38"	18.88"

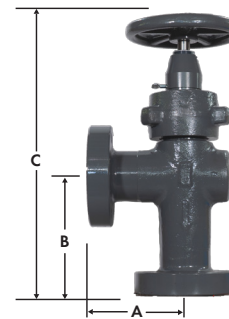

EJWA

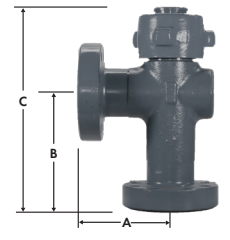

EPC

EZ FLOW MODEL	Flange Size Inlet/Outlet	Working Pressure	Orifice Size	Dimensions		
				A	B	C
EH2A	3 1/8" 3M	3,000	3/4", 1", 2" Max	8.88"	11.38"	30.00"
EH2P				8.88"	11.38"	18.50"
EH2A	2 1/16" 5M	5,000	3/4", 1", 2" Max	7.50"	9.38"	30.00"
EH2P				7.50"	9.38"	18.50"
EH2A	2 9/16" 5M	5,000	3/4", 1", 2" Max	8.88"	11.38"	30.00"
EH2P				8.88"	11.38"	18.50"
EH2A	3 1/8" 5M	5,000	3/4", 1", 2" Max	8.88"	11.38"	30.00"
EH2P				8.88"	11.38"	18.50"
EH2A	2 9/16" 10M	10,000	3/4", 1", 2" Max	10.38"	11.75"	30.25"
EH2P				10.38"	11.75"	18.75"
EH2A	3 1/16" 10M	10,000	3/4", 1", 2" Max	10.38"	11.75"	30.25"
EH2P				10.38"	11.75"	18.75"

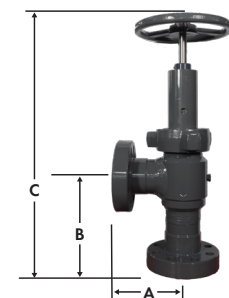

EH2A

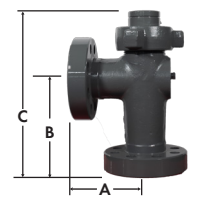

EH2P

- Not all flange sizes are listed, please inquire for any size not mentioned above
- Fabricated flanged E-N60 (E-F60) configurations are available upon request
- Straight stainless steel trim is available upon request

LONG NOSE HEATER CHOKES

EZ FLOW CONTROL's adjustable or positive configurations are available for long nose heater chokes. Trim material options include hardened steel and stainless steel tungsten carbide. All parts and choke assemblies are interchangeable with standard economy heater chokes.

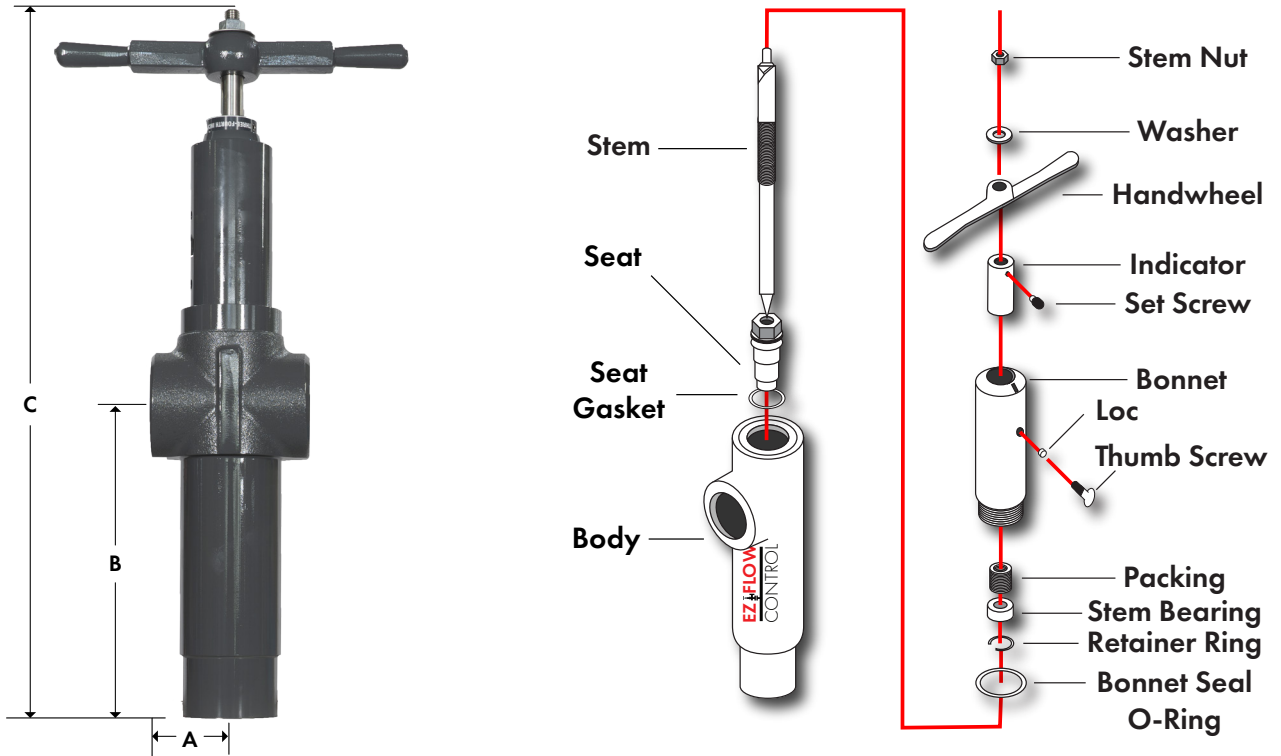

EZ FLOW MODEL	Inlet/Outlet	Working Pressure	Orifice Size	Dimensions		
				A	B	C
E65LHC	2"FLP/2"FLP	6,500	1/2", 3/4" & 1"	3.25"	12.25"	28.50"
E65SHC	2"SW/2"SW					
E78LHC	2"FLP/2"FLP	7,800	1/2", 3/4" & 1"	3.25"	12.25"	28.50"
E78SHC	2"SW/2"SW					
E94BHC	2"XXHBW/2"XXHBW	9,400	1/2", 3/4" & 1"	5.38"	12.50"	30.00"

- 1/2" Trim is not stock but available upon request
- Straight stainless steel trim is available upon request

EZ FLOW FEATURES:

- Available for NACE / H2S service
- Available for actuator configuration
- Line pipe, butt weld, and socket-weld connections are available
- Standard 4" Barrel Body

TALCO 1502 FLOW CONTROL PRODUCTS

EZ FLOW CONTROL'S **TALCO** adjustable choke for 1502 high pressure manifold systems.
H2S/NACE and actuation options for this choke available upon request

TALCO 1502 ADJUSTABLE CHOKE

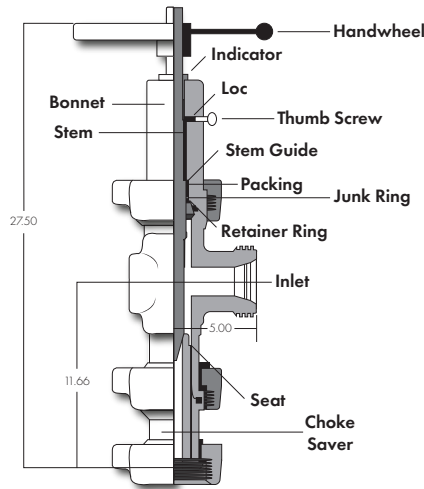
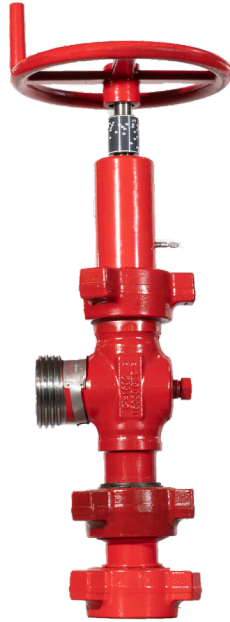

WORKING PRESSURE
10,000 & 15,000 NSCPW

END CONNECTIONS
2" Fig 1502 Hammer Union
3" Fig 1502 Hammer Union

ORIFICE SIZE
3/4"-2" Max SSTC

TRIM MATERIAL
Stainless steel- tungsten carbide

Typical TALCO 2" 1502 adjustable choke

TALCO MANIFOLD SYSTEMS

- All Manifold components are interchangeable industry wide
- All choke/valve configurations offered
- 1", 2", and 3" connections available
- H2S/NACE and actuation available
- Offered with or without a skid
- All lip seal configurations offered



TALCO 1502 FITTINGS, ADAPTERS, PUP JOINTS, SPACERS, AND SWIVELS

- All connection configurations available for crosses and tees
- 1", 2", and 3" connections available
- Style 50 and 10 swivels stocked
- NPS or Integral pup joints stocked
- 1'-8', 10', and 20' pup joint lengths stocked



ELLS



TEES



CHOKE SAVERS



SPACERS



SWIVELS



CROSSES



PUP JOINTS



UNION X FLG
ADAPTERS

www.ezflowcontrol.com
405-429-7584

TALCO 1502 FLOW CONTROL PRODUCTS

TALCO 1502 EZ-LT PLUG VALVE

FEATURES:

- Low Torque - 1/4 Turn for open or close
- 10-15M working pressure
- 1502 Union, threaded, or flanged end connections
- All parts interchangeable industry wide
- Actuation options available upon request
- H2S/NACE service offered upon request

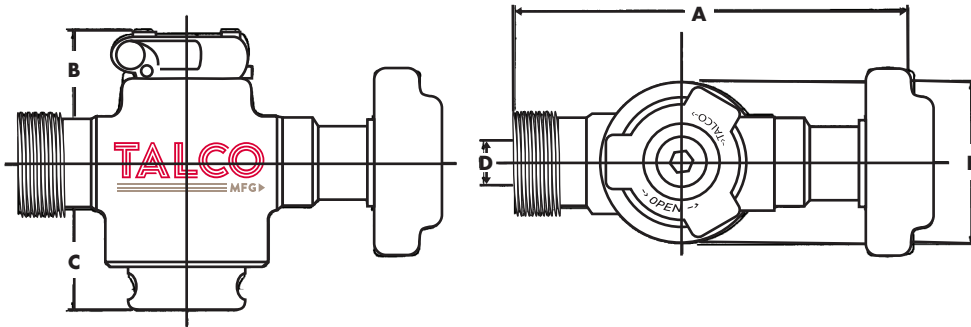

Valve Size	End Connections	Working Pressure	Service	WT (LBS)	A	B	C	D	E
1"	1" 1502 FxM	15,000	STANDARD	42	10.56	4.69	4.56	1.00	5.38
1"	2" 1502 FxM	15,000	STANDARD	52	10.56	4.69	4.56	1.00	5.38
2"	2" 1502 FxM	15,000	STANDARD	92	13.88	5.34	5.50	2.06	7.00
3"	3" 1502 FxM	15,000	STANDARD	196	17.00	7.20	10.95	3.05	10.20

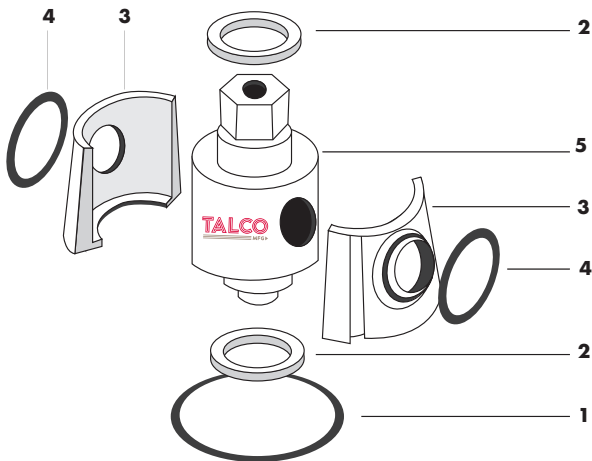

TALCO EZLT LO-TORQUE 15M PLUG VALVE REPAIR KIT		
No.	Description	QTY
1	Adj Nut O-Ring	1
2	Plug Stem Seal	2
3	Inserts (2 per set)	1
4	Insert O-Ring	2
5	Plug	1
	Seal Kit 1, 2, & 4	
	Hard Kit 3 & 5	1
	Repair Kit 1-5	1

FLOW CONTROL COMPONENTS

CAGE NIPPLES & CHOKE NIPPLES

- Offered in an array of length and connection sizes
- Choke Nipples offered in drill-through, ceramic, or carbide
- H2S/NACE service available
- Oriface increments in 64ths of an inch



HYDRAULIC CHOKE TRIM SET

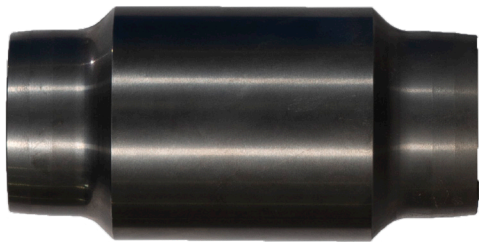

Hydraulic Gate

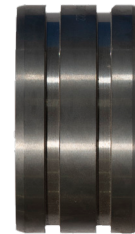

Hydraulic Seat

FLOW BEAN WRENCHES



Wrench profiles offered: Oil Center Tools, Heater Choke, and Cameron

POSITIVE FLOW BEANS

Choke Flow Beans available in alloy steel or stainless steel jackets

TRIM MATERIALS OFFERED		
1" MAX (04-64/64")	FULLY LINED	Ceramic or carbide trim
2" MAX (04-128/64")		

Oil Center Tool

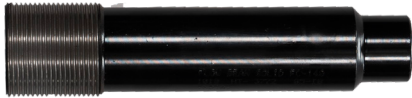

TUNGSTEN CARBIDE
"FC-140"



CERAMIC
"FC-140"

Thornhill-Craver



TC 1003 P

Cameron Iron Works



1" Max BJ



2" Max BJ



BJ 2" Max x BJ 1" Max

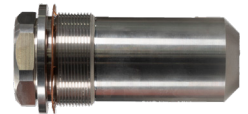

BJ 2" Max x OCT FC-140

All choke flow bean profiles offered in a straight stainless steel with orifice drill-through available upon request

ADJUSTABLE CHOKE STEMS & SEATS

Trim: Hardened steel, stainless-steel, and stainless steel tungsten-carbide

Oil Center Tool

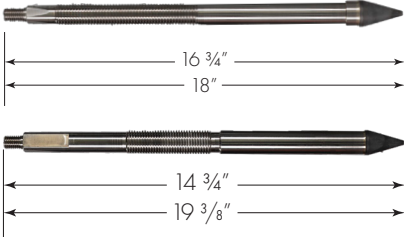

Offered in partially or fully lined carbide

Item	Length	Choke	Material
A	16 3/4"	N-60 / FT-116A	SS/TC
B	18"	N-62	SS/TC
C	14 3/4"	5m / 10m	SS/TC
D	19 3/8"	JWA 15m	SS/TC

Thornhill-Craver

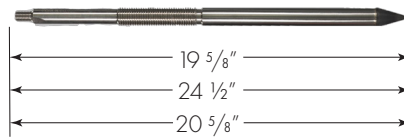

Offered in partially or fully lined carbide

Item	Length	Choke	Material
A	19 5/8"	TC-894 3m/5m/10m	SS/TC
B	24 1/2"	TC-899 3m/5m/10m	SS/TC
C	20 5/8"	TC-2491 15m HEATER	SS/TC

Cameron Iron Works

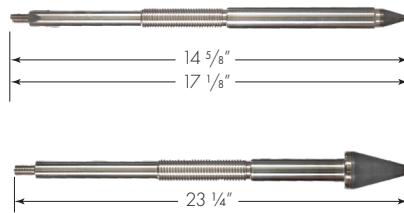

Offered in partially or fully lined carbide



Offered in partially or fully lined carbide

Item	Length	Choke	Material
A	14 5/8"	H2 1" MAX 3m/5m/10m	SS/TC
B	17 1/8"	H2 1" MAX 15m	SS/TC

TALCO 1502 15M



Offered in partially or fully lined carbide

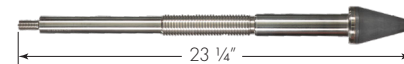

Offered in partially or fully lined carbide

Item	Length	Choke	Material
A	22	2" 1502 TXS 1" Max	SS/TC
B	24 1/2	3" 1502 TXS 2" Max	SS/TC

FLOW CONTROL PARTS



Not seeing what you are looking for? Upon request EZ Flow Control has the capabilities to manufacture other choke trim and repair parts for the following profiles:

- McEvoy & Atlas Hughes
- National Supply
- Gulfco
- Gray Tool Company

EZ FLOW
CONTROL

13

www.ezflowcontrol.com
405-429-7584

EZ FLOW CONTROL INC.
A BelGAS Company
“STANDARD TERMS and CONDITIONS”

QUOTATIONS: All quotations, prices, and sales are F.O.B. factory unless otherwise expressly stated in writing. Quotations are for immediate acceptance unless a definite period of time is stated within which acceptance may be made. All prices and discounts, now ineffect, or hereafter issued, are subject to change without notice. Requests for quotations on products for export should be sent directly to EZ FLOW CONTROL, INC., 2221 SE 69th St. Oklahoma City, OK 73149 USA, or www.ezflowcontrol.com. Unless otherwise agreed in writing, litherage, wharfage of lading fees, duties, or any other charges at destination are not included in quotations. Counselor's fees for legalizing invoices, stamping bills of lading, import duty, or other documents required by the laws of any country of destination, are not included in quotation or selling prices. Upon proper written instructions, EZ FLOW will attempt to arrange for Consular documents and declaration, as agents of the customer, but EZ FLOW assumes no responsibility for any damages, liability, fines, or charges imposed due to errors or incorrect declarations.

GUARANTEE: Products of EZ FLOW are guaranteed against defects of material and workmanship for one year from date of invoice, provided such products are used normally and within the service and pressure range for which they were manufactured. Claims for a breach of this guarantee shall be limited to replacement, free of charge, of any part or product that proves to be defective in material or workmanship, as deemed by EZ FLOW, upon written notice of such defect given in thirty (30) days and return of such item to EZ FLOW. Costs of labor, freight, drayage, or other similar charges shall be at the customer's expense. This warranty is limited in extent to the warranty, if any, which the user receives from the manufacturers of any component parts. **ALL OTHER WARRANTIES OR LIABILITIES EXPRESSED, IMPLIED, ORAL OR STATUTORY, INCLUDING ANY WARRANTY OF MERCHANTABILITY OR FITNESS FOR A PARTICULAR PURPOSE ARE EXPRESSLY DENIED.** In no event shall the company, its agents or employees be liable for injury or damage to any person or property whatsoever or for any special, indirect, secondary, or consequential damage of any nature however arising.

PACKING: EZ FLOW endeavors to pack or prepare all shipments so that they will not break, rust, or deteriorate in transit, but does not guarantee against damage. All claims regarding shortages must be made in writing within ten (10) days from receipt of shipment and must be accompanied by the packing list. Shipments may be insured by the customer against damage or loss in transit upon written request, but in such cases EZ FLOW acts only as an agent without recourse between the insurance company and the customer and assumes no liability whatsoever.

DELIVERY: Delivery date estimates are made as accurately as possible and every effort will be made to meet such delivery target, but EZ FLOW will assume no further or implied liability for damages arising from failure to deliver material within the time specified. EZ FLOW's responsibility for risk of loss or damage in transit ceases on delivery any common carrier.

CANCELLATIONS: Orders once placed and accepted can be cancelled only with the consent of and upon terms acceptable to EZ FLOW. Deposits or prepayments shall be considered liquidated damages at the option of EZ FLOW, which shall not, however, be limited to such remedies for any breach or cancellation of an order.

RETURN OF MATERIAL: Merchandise may be returned for credit or adjustment only with EZ FLOW's written permission. Items manufactured of special design, size, or material will not be accepted for credit, however, nor will cancellation of such orders be accepted, without full compensation to EZ FLOW for all expenses incurred after such orders are in production. Products classified by EZ FLOW, as special design or those not conforming to our standard line, are not accepted for credit. Merchandise approved for return will be subject to our inspection and to a charge for reconditioning and restocking, and merchandise credit only will be issued based on the net purchased invoice price less freight charges.

TERMS OF PAYMENT: Unless otherwise specified, all invoices are due net thirty (30) days from date of invoice. No orders shall be considered as accepted by the company until approved through EZ FLOW's office.

FREIGHT CHARGES AND ALLOWANCES: All freight is shipped FOB EZ FLOW Facility unless agreed upon in writing by EZ FLOW and customer.

CHANGE OF DESIGN: EZ FLOW reserves the right to change or modify the design or construction of any product or the manufacturing process thereof produced by EZ FLOW without notice to customer and without any obligation to furnish or install such changes or modifications on products previously or subsequently sold.

TAXES: The purchaser shall pay any tax or other charge imposed by law on the sale or production of goods

NOTES

EZ FLOW

CONTROL



EZ FLOW
2221 SE 69th St
Oklahoma City, OK 73149

www.ezflowcontrol.com
405-429-7584

BelGAS CP
2221 SE 69th St
Oklahoma City, OK 73149

www.belgascp.com
405-813-0011